

Power contactor, AC-3 32 A, 15 kW / 400 V 42 V DC, 3-pole, 2 NO + 2 NC, Size S2, Screw terminal !!! Phased-out product !!! Successor is SIRIUS 3RT2



Figure similar

| | |
|---|------------------------|
| Product brand name | SIRIUS |
| Product designation | power contactor |
| General technical data | |
| Size of contactor | S2 |
| Insulation voltage | |
| • rated value | 690 V |
| Degree of pollution | 3 |
| Surge voltage resistance rated value | 6 kV |
| maximum permissible voltage for safe isolation | |
| • between coil and main contacts acc. to EN 60947-1 | 400 V |
| Protection class IP | |
| • on the front | IP20 |
| • of the terminal | IP00 |
| Shock resistance at rectangular impulse | |
| • at DC | 10g / 5 ms, 5g / 10 ms |
| Shock resistance with sine pulse | |

| | |
|---|------------------------|
| • at DC | 15g / 5 ms, 8g / 10 ms |
| Mechanical service life (switching cycles) | |
| • of contactor typical | 10 000 000 |
| • of the contactor with added electronics-compatible auxiliary switch block typical | 5 000 000 |
| • of the contactor with added auxiliary switch block typical | 10 000 000 |
| Reference code acc. to DIN EN 81346-2 | Q |

Ambient conditions

| | |
|--|----------------|
| Installation altitude at height above sea level | |
| • maximum | 2 000 m |
| Ambient temperature | |
| • during operation | -25 ... +60 °C |
| • during storage | -55 ... +80 °C |

Main circuit

| | |
|--|--------------------|
| Number of poles for main current circuit | 3 |
| Number of NO contacts for main contacts | 3 |
| Number of NC contacts for main contacts | 0 |
| Operating current | |
| • at AC-1 at 400 V | |
| — at ambient temperature 40 °C rated value | 50 A |
| • at AC-1 | |
| — up to 690 V at ambient temperature 40 °C rated value | 50 A |
| — up to 690 V at ambient temperature 60 °C rated value | 45 A |
| • at AC-3 | |
| — at 400 V rated value | 32 A |
| — at 690 V rated value | 20 A |
| • at AC-4 at 400 V rated value | 29 A |
| Connectable conductor cross-section in main circuit at AC-1 | |
| • at 60 °C minimum permissible | 10 mm ² |
| • at 40 °C minimum permissible | 16 mm ² |
| Operating current for approx. 200000 operating cycles at AC-4 | |
| • at 400 V rated value | 15.6 A |
| • at 690 V rated value | 11 A |
| Operating current | |
| • at 1 current path at DC-1 | |
| — at 24 V rated value | 45 A |
| — at 110 V rated value | 4.5 A |

| | |
|--|---|
| <ul style="list-style-type: none"> • with 2 current paths in series at DC-1 <ul style="list-style-type: none"> — at 24 V rated value — at 110 V rated value • with 3 current paths in series at DC-1 <ul style="list-style-type: none"> — at 24 V rated value — at 110 V rated value | <p>45 A</p> <p>25 A</p> <p>45 A</p> <p>45 A</p> |
| Operating current | |
| <ul style="list-style-type: none"> • at 1 current path at DC-3 at DC-5 <ul style="list-style-type: none"> — at 24 V rated value — at 110 V rated value • with 2 current paths in series at DC-3 at DC-5 <ul style="list-style-type: none"> — at 24 V rated value — at 110 V rated value • with 3 current paths in series at DC-3 at DC-5 <ul style="list-style-type: none"> — at 24 V rated value — at 110 V rated value | <p>35 A</p> <p>2.5 A</p> <p>45 A</p> <p>25 A</p> <p>45 A</p> <p>45 A</p> |
| Operating power | |
| <ul style="list-style-type: none"> • at AC-1 <ul style="list-style-type: none"> — at 230 V at 60 °C rated value — at 400 V rated value — at 690 V rated value — at 690 V at 60 °C rated value • at AC-2 at 400 V rated value • at AC-3 <ul style="list-style-type: none"> — at 230 V rated value — at 400 V rated value — at 500 V rated value — at 690 V rated value | <p>18 kW</p> <p>31 kW</p> <p>54 kW</p> <p>54 kW</p> <p>15 kW</p> <p>7.5 kW</p> <p>15 kW</p> <p>18.5 kW</p> <p>18.5 kW</p> |
| Operating power for approx. 200000 operating cycles at AC-4 | |
| <ul style="list-style-type: none"> • at 400 V rated value • at 690 V rated value | <p>8.2 kW</p> <p>10 kW</p> |
| Thermal short-time current limited to 10 s | |
| | 320 A |
| Power loss [W] at AC-3 at 400 V for rated value of the operating current per conductor | |
| | 1.8 W |
| No-load switching frequency | |
| <ul style="list-style-type: none"> • at DC | 1 500 1/h |
| Operating frequency | |
| <ul style="list-style-type: none"> • at AC-1 maximum • at AC-2 maximum • at AC-3 maximum • at AC-4 maximum | <p>1 200 1/h</p> <p>750 1/h</p> <p>1 000 1/h</p> <p>250 1/h</p> |

| Control circuit/ Control | |
|--|--------------|
| Type of voltage of the control supply voltage | DC |
| Control supply voltage at DC | |
| • rated value | 42 V |
| Operating range factor control supply voltage rated value of magnet coil at DC | |
| • initial value | 0.8 |
| • Full-scale value | 1.1 |
| Closing power of magnet coil at DC | 13.3 W |
| Holding power of magnet coil at DC | 13.3 W |
| Closing delay | |
| • at DC | 50 ... 95 ms |
| Opening delay | |
| • at DC | 20 ... 30 ms |
| Arcing time | 10 ... 15 ms |

| Auxiliary circuit | |
|--|---|
| Number of NC contacts for auxiliary contacts | |
| • instantaneous contact | 2 |
| Number of NO contacts for auxiliary contacts | |
| • instantaneous contact | 2 |
| Operating current at AC-12 maximum | 10 A |
| Operating current at AC-15 | |
| • at 230 V rated value | 6 A |
| • at 400 V rated value | 3 A |
| Operating current at DC-12 | |
| • at 60 V rated value | 6 A |
| • at 110 V rated value | 3 A |
| • at 220 V rated value | 1 A |
| Operating current at DC-13 | |
| • at 24 V rated value | 10 A |
| • at 60 V rated value | 2 A |
| • at 110 V rated value | 1 A |
| • at 220 V rated value | 0.3 A |
| Contact reliability of auxiliary contacts | 1 faulty switching per 100 million (17 V, 1 mA) |

| UL/CSA ratings | |
|--|-------------|
| Contact rating of auxiliary contacts according to UL | A600 / Q600 |

| Short-circuit protection | |
|--|-------------------|
| Design of the fuse link | |
| • for short-circuit protection of the main circuit | |
| — with type of coordination 1 required | fuse gL/gG: 125 A |
| — with type of assignment 2 required | fuse gL/gG: 63 A |

- for short-circuit protection of the auxiliary switch required

fuse gL/gG: 10 A

Installation/ mounting/ dimensions

| | |
|---|--|
| Mounting type | screw and snap-on mounting onto 35 mm standard mounting rail according to DIN EN 50022 |
| <ul style="list-style-type: none"> • Side-by-side mounting | Yes |
| Height | 112 mm |
| Width | 55 mm |
| Depth | 179 mm |
| Required spacing | |
| <ul style="list-style-type: none"> • for grounded parts <ul style="list-style-type: none"> — at the side | 6 mm |

Connections/Terminals

| | |
|--|--|
| Type of electrical connection | |
| <ul style="list-style-type: none"> • for main current circuit | screw-type terminals |
| <ul style="list-style-type: none"> • for auxiliary and control current circuit | screw-type terminals |
| Type of connectable conductor cross-sections | |
| <ul style="list-style-type: none"> • for main contacts <ul style="list-style-type: none"> — solid — stranded — single or multi-stranded — finely stranded with core end processing — finely stranded without core end processing • at AWG conductors for main contacts | 2x (0.75 ... 16 mm ²) 2x (0.75 ... 25 mm ²) 2x (0,75 ... 16 mm ²) 2x (0.75 ... 16 mm ²) 2x (0.75 ... 16 mm ²) 2x (18 ... 2) |
| Type of connectable conductor cross-sections | |
| <ul style="list-style-type: none"> • for auxiliary contacts <ul style="list-style-type: none"> — solid — finely stranded with core end processing • at AWG conductors for auxiliary contacts | 2x (0.5 ... 1.5 mm ²), 2x (0.75 ... 2.5 mm ²), max. 2x (0.75 ... 4 mm ²) 2x (0.5 ... 1.5 mm ²), 2x (0.75 ... 2.5 mm ²) 2x (20 ... 16), 2x (18 ... 14), 1x 12 |

Certificates/approvals

| | | |
|--------------------------|---------------------------------------|---------------------------|
| General Product Approval | Functional Safety/Safety of Machinery | Declaration of Conformity |
|--------------------------|---------------------------------------|---------------------------|



[Type Examination Certificate](#)



| | |
|-------------------|-------------------|
| Test Certificates | Marine / Shipping |
|-------------------|-------------------|

[Type Test Certificates/Test Report](#)

[Special Test Certificate](#)

[Miscellaneous](#)



| | |
|-------------------|-------|
| Marine / Shipping | other |
|-------------------|-------|



[Confirmation](#)

[Miscellaneous](#)

Further information

Information- and Downloadcenter (Catalogs, Brochures,...)

<http://www.siemens.com/industrial-controls/catalogs>

Industry Mall (Online ordering system)

<https://mall.industry.siemens.com/mall/en/en/Catalog/product?mlfb=3RT1034-1BD44>

Cax online generator

<http://support.automation.siemens.com/WW/CAXorder/default.aspx?lang=en&mlfb=3RT1034-1BD44>

Service&Support (Manuals, Certificates, Characteristics, FAQs,...)

<https://support.industry.siemens.com/cs/ww/en/ps/3RT1034-1BD44>

Image database (product images, 2D dimension drawings, 3D models, device circuit diagrams, EPLAN macros, ...)

http://www.automation.siemens.com/bilddb/cax_de.aspx?mlfb=3RT1034-1BD44&lang=en

Characteristic: Tripping characteristics, I²t, Let-through current

<https://support.industry.siemens.com/cs/ww/en/ps/3RT1034-1BD44/char>

Further characteristics (e.g. electrical endurance, switching frequency)

<http://www.automation.siemens.com/bilddb/index.aspx?view=Search&mlfb=3RT1034-1BD44&objecttype=14&gridview=view1>

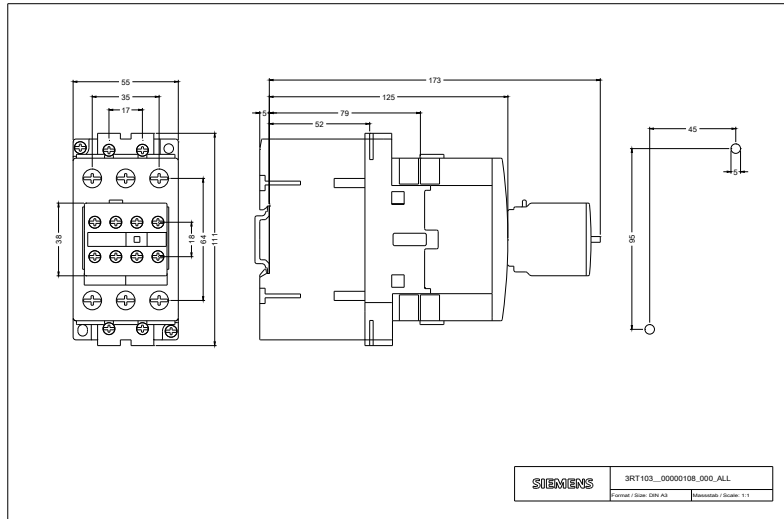

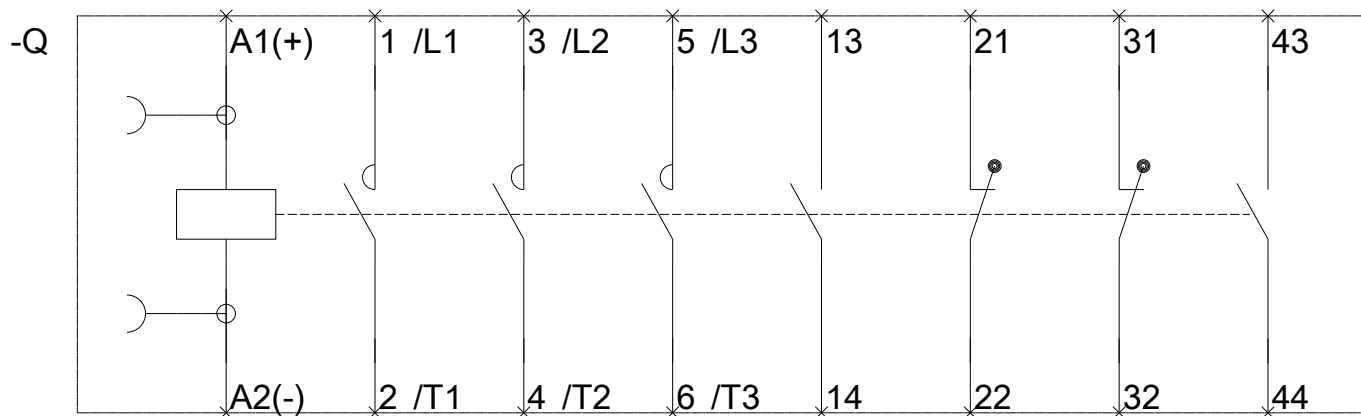

last modified:

12/13/2018